

PROPERTY'S DATA		
Point	Bearing	Distance (m)
1 - 2	S 01°15'19" W	09.81
2 - 3	S 01°59'41" W	08.99
3 - 4	S 01°43'30" W	09.80
4 - 5	S 08°41'12" E	24.37
5 - 6	S 86°40'53" E	30.21
6 - 7	S 76°53'20" E	26.16
7 - 8	S 81°00'41" E	21.97
8 - 9	N 02°44'19" E	23.59
9 - 10	N 03°39'40" E	36.00
10 - 11	N 02°50'50" E	16.07
11 - 12	N 02°56'58" E	11.78
12 - 13	N 80°02'36" W	00.65
13 - 14	N 56°10'37" W	20.43
14 - 15	N 50°51'51" W	18.20
15 - 16	S 11°23'35" W	14.32
16 - 17	S 26°21'19" W	17.23
17 - 18	S 35°17'02" W	11.58
18 - 19	S 37°48'35" W	13.84
19 - 20	N 82°22'43" W	21.30
20 - 1	N 84°59'51" W	06.57

AREA = 6,101.82 m²

AREA = 1.507 ACRES

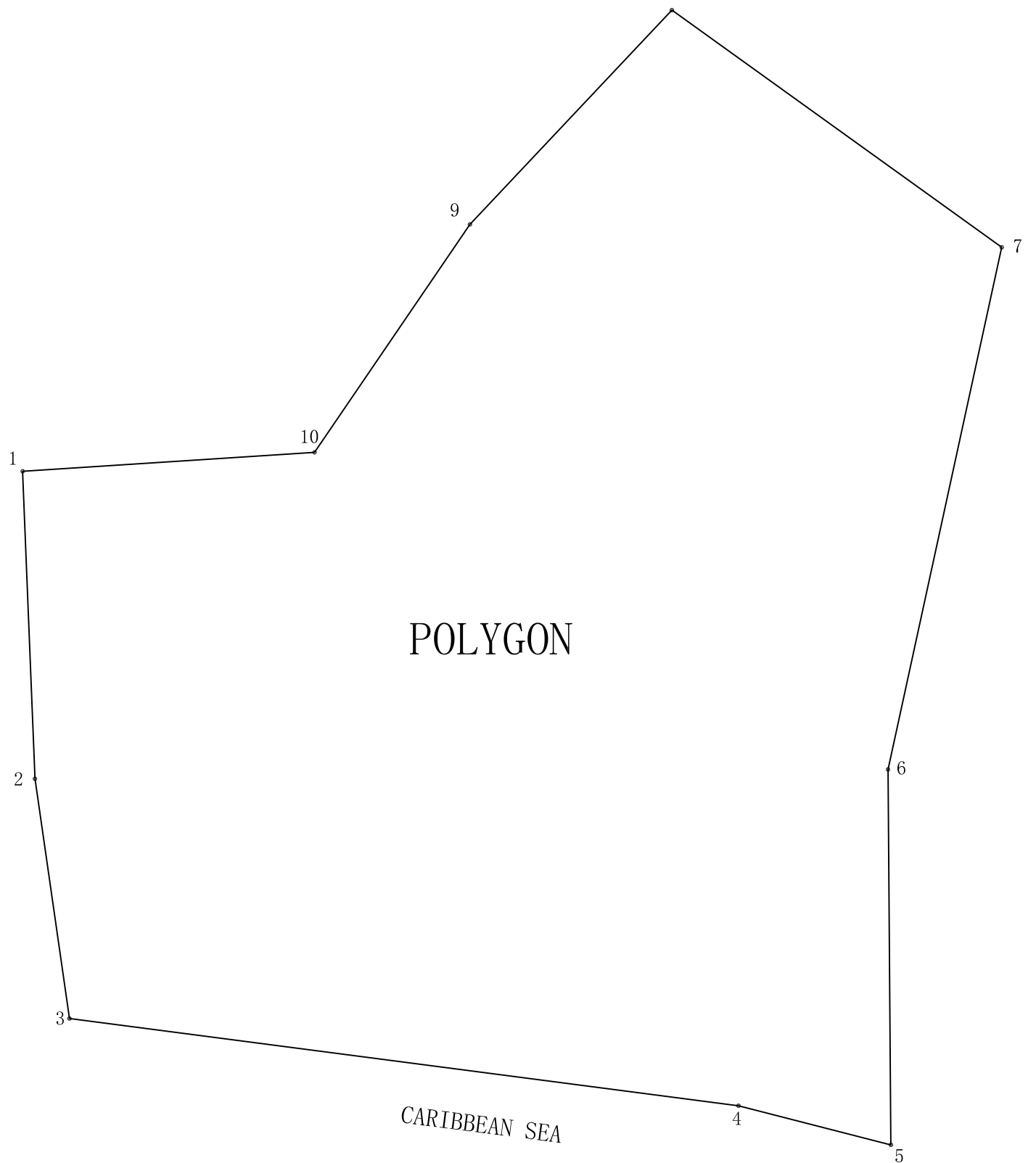

West End, Roatan, Honduras

NAME: HALF MOON RESORT
LOCATION: HALF MOON BAY, WEST END, ROATAN,
HONDURAS, 34101
SCALE: 1 : 500
DATE OF SURVEY: MAY, 2019.
SURVEYED BY: MARCO ANTONIO VALLADARES
ELABORATED BY: ING. ANDREA MURILLO GALINDO
PAGE: 1 of 2

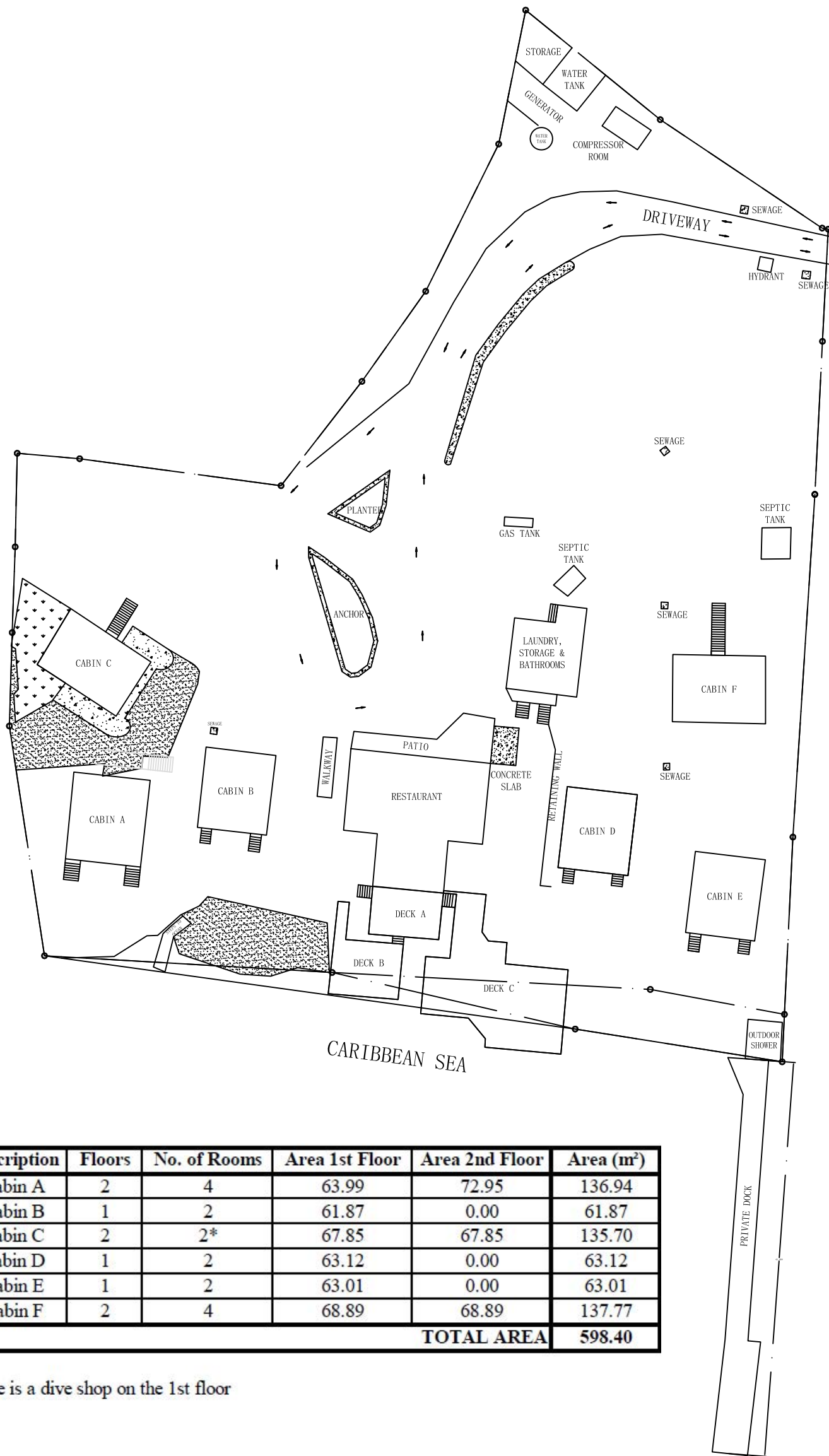

No	Description	Floors	No. of Rooms	Area 1st Floor	Area 2nd Floor	Area (m ²)
1	Cabin A	2	4	63.99	72.95	136.94
2	Cabin B	1	2	61.87	0.00	61.87
3	Cabin C	2	2*	67.85	67.85	135.70
4	Cabin D	1	2	63.12	0.00	63.12
5	Cabin E	1	2	63.01	0.00	63.01
6	Cabin F	2	4	68.89	68.89	137.77
TOTAL AREA						598.40

* There is a dive shop on the 1st floor

No	Description	Area (m ²)
1	Restaurant	166.76
2	Deck A	36.85
3	Deck B	47.38
4	Deck C	143.74
5	Laundry, Storage & Bathroom	61.29
6	Dock	118.65



West End, Roatan, Honduras



NAME: HALF MOON RESORT
LOCATION: HALF MOON BAY, WEST END, ROATAN, HONDURAS, 34101
SCALE: 1 : 500
DATE OF SURVEY: MAY, 2019.
SURVEYED BY: MARCO ANTONIO VALLADARES
ELABORATED BY: ING. ANDREA MURILLO GALINDO
PAGE: 2 of 2